



Gets on your couch's  
**good side.**

# Barrister Home Side Table

Model 5420330

**NOTE:** THIS INSTRUCTION  
BOOKLET CONTAINS **IMPORTANT**  
SAFETY INFORMATION.

PLEASE READ AND KEEP FOR  
FUTURE REFERENCE.

# Table of Contents

# Assembly Tools Required

Part Identification 3

Hardware Identification 4

Assembly Steps 5-23

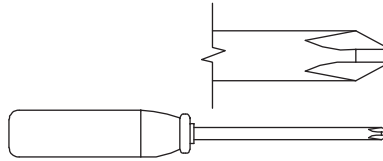

No. 2 Phillips Screwdriver  
Tip Shown Actual Size

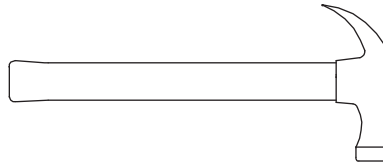

Hammer  
Not actual size 😊

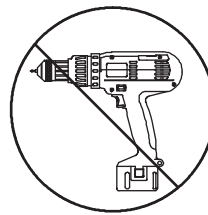

Skip the power trip.  
This time.

# Part Identification

Now you know  
our ABCs.



While not all parts are labeled, some of the parts will have a label or an inked letter on the edge to help distinguish similar parts from each other. Use this part identification to help identify similar parts.

A	RIGHT END (1)
B	LEFT END (1)
C	TOP (1)
D	BOTTOM (1)
E	SHELF (1)
F	BACK (1)
G	BASE (2)
H	SIDE BASE (2)
I	VALANCE (1)
J	DRAWER FRONT (1)
K	SIDE TOP MOLDING (2)
L	TOP MOLDING (2)
M	END MOLDING (4)
P	PLINTH (4)
D22	DRAWER RIGHT SIDE (1)
D23	DRAWER LEFT SIDE (1)
D77	DRAWER BACK (1)
D706	DRAWER BOTTOM (1)

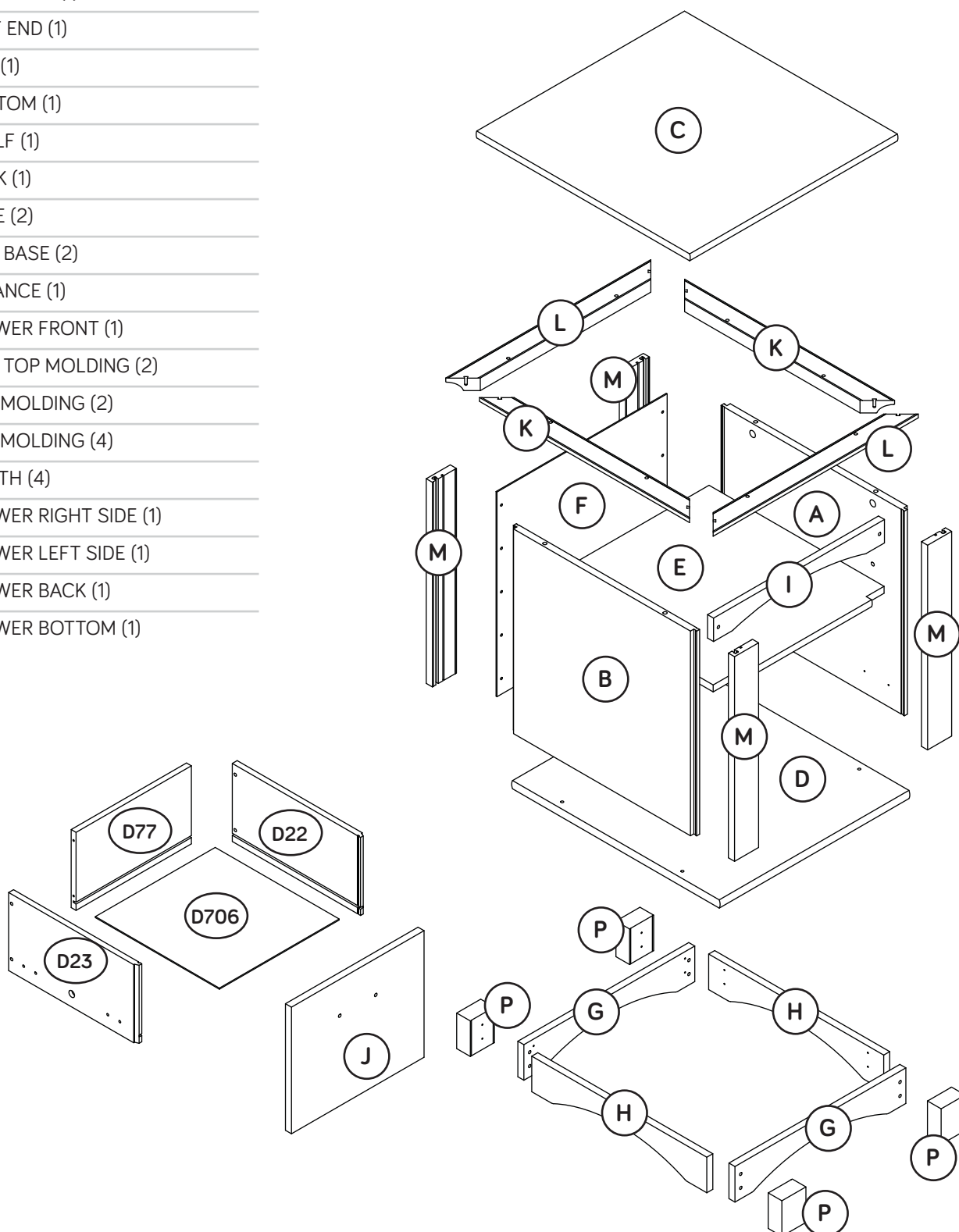

# Hardware Identification

↑ Screws are shown actual size. You may receive extra hardware with your unit.

**35AA** UNIVERSAL CABINET RAIL - 2

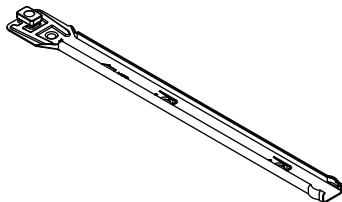

**35AC** DRAWER RIGHT - 1

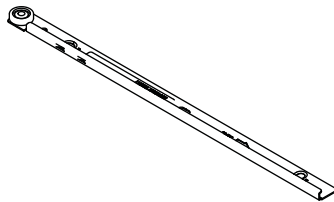

**35AD** DRAWER LEFT - 1

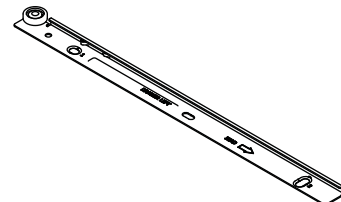

**10A** SLIDE CAM - 2



**1F** HIDDEN CAM - 8

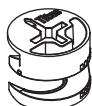

**2F** CAM DOWEL - 8

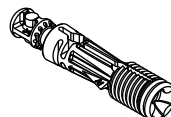

**17F** MOLDING CONNECTOR - 4



**31G** CORNER BRACKET - 4

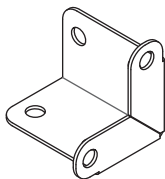

**45G** EXTENSION BRACKET - 4

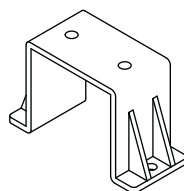

**98K** PULL - 1

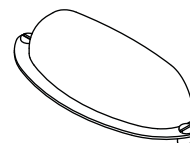

**1S** BLACK 9/16" LARGE HEAD SCREW - 42

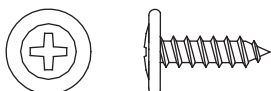

**3S** GOLD 5/16" FLAT HEAD SCREW - 8



**10S** SILVER 1-1/8" FLAT HEAD SCREW - 10

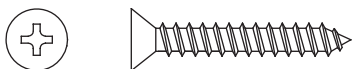

**15S** SILVER 5/8" MACHINE SCREW - 2



**30S** BLACK 1-9/16" FLAT HEAD SCREW - 4

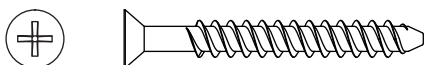

**55S** BROWN 1-5/8" FLAT HEAD SCREW - 8

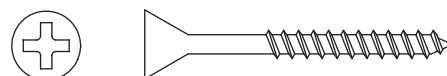

**113S** BLACK 1-15/16" FLAT HEAD SCREW - 4



# Step 1

- ✚ Assemble your unit on a carpeted floor or on the empty carton to avoid scratching your unit or the floor.
- ✚ Push eight HIDDEN CAMS (1F) into the ENDS (A and B) and SHELF (E). Then, insert the metal end of a CAM DOWEL (2F) into each HIDDEN CAM.

Do not tighten the HIDDEN CAMS in this step.

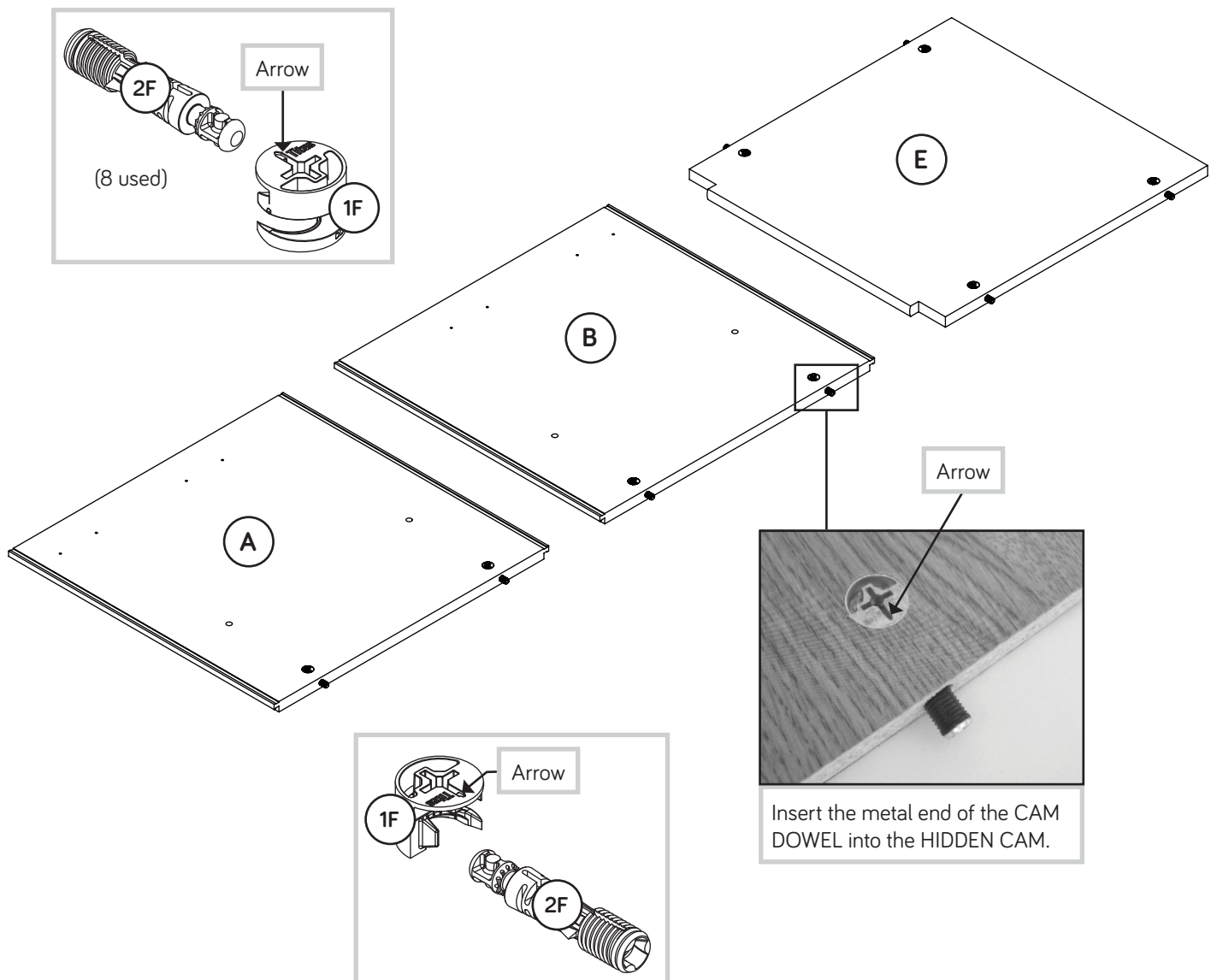

## Step 2

- Tap four MOLDING CONNECTORS (17F) into the notches in the TOP MOLDINGS (K and L).

Use your hammer to tap the MOLDING CONNECTORS (17F) into the notches in the TOP MOLDINGS.

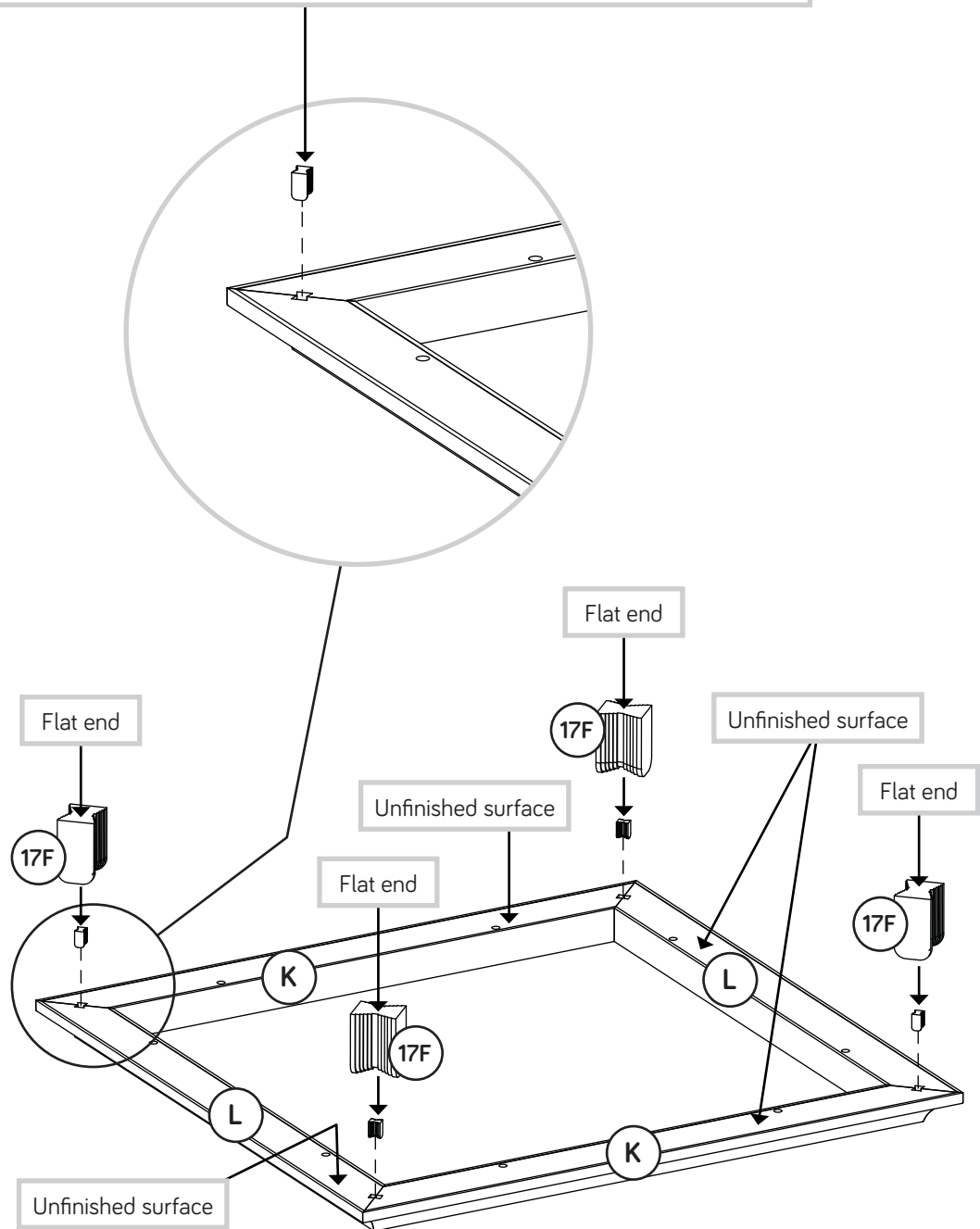

# Step 3

- ✚ Carefully turn the assembled TOP MOLDINGS (K and L) over.
- ✚ Fasten the TOP MOLDINGS (K and L) to the TOP (C). Use eight BROWN 1-5/8" FLAT HEAD SCREWS (55S).
- ✚ NOTE: Do not overtighten the SCREWS into the TOP.



Remember:  
Righty tighty.  
Lefty loosey.

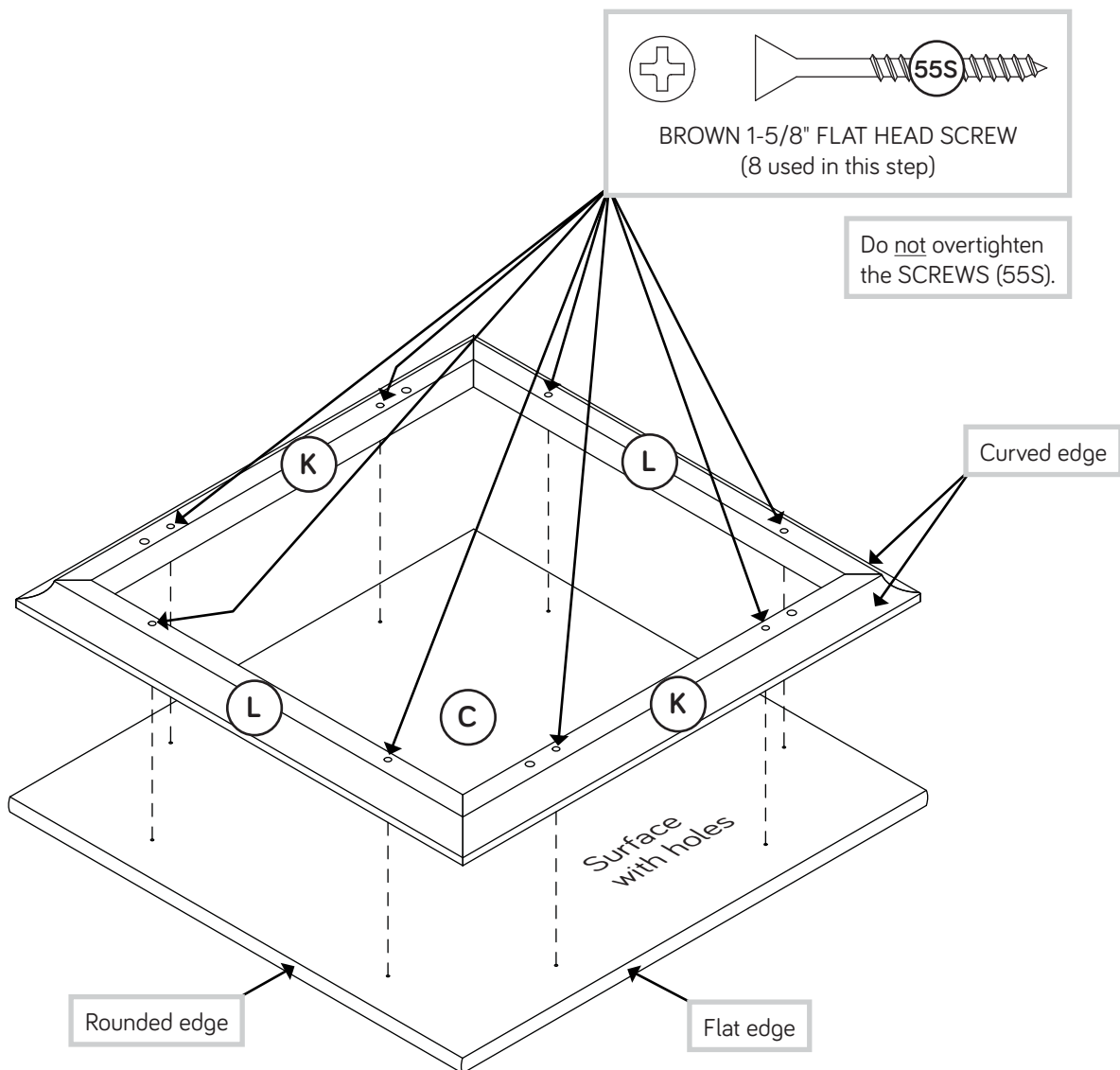

# Step 4

✚ Slide the END MOLDINGS (M) onto the notched edges of the ENDS (A and B).

✚ \*U.S. Patent No. 5,499,886

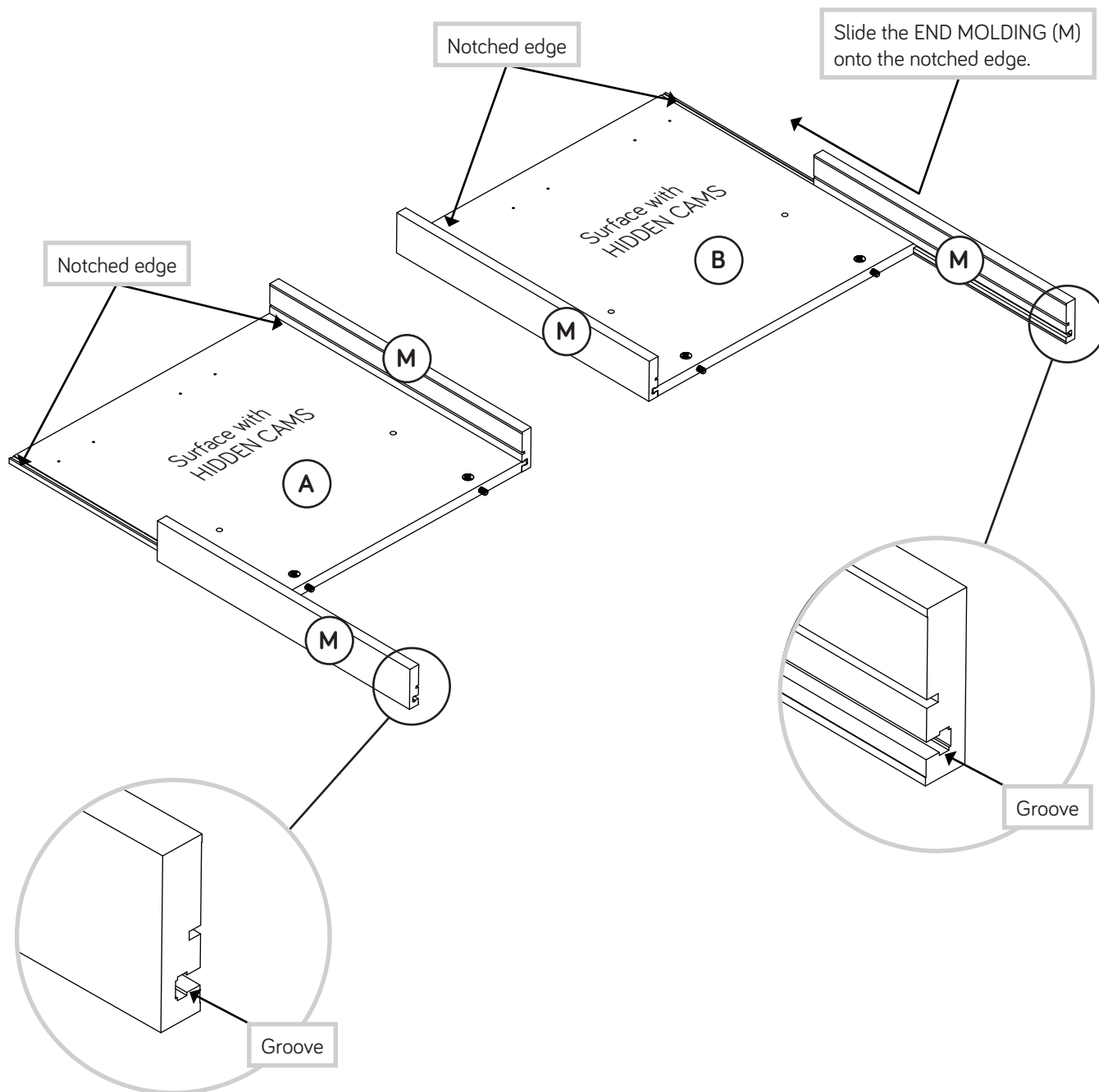

# Step 5

- Place the BACK (F) on edge on the LEFT END (B) against the END MOLDING (M).
- Fasten the SHELF (E) to the LEFT END (B). Tighten two HIDDEN CAMS.

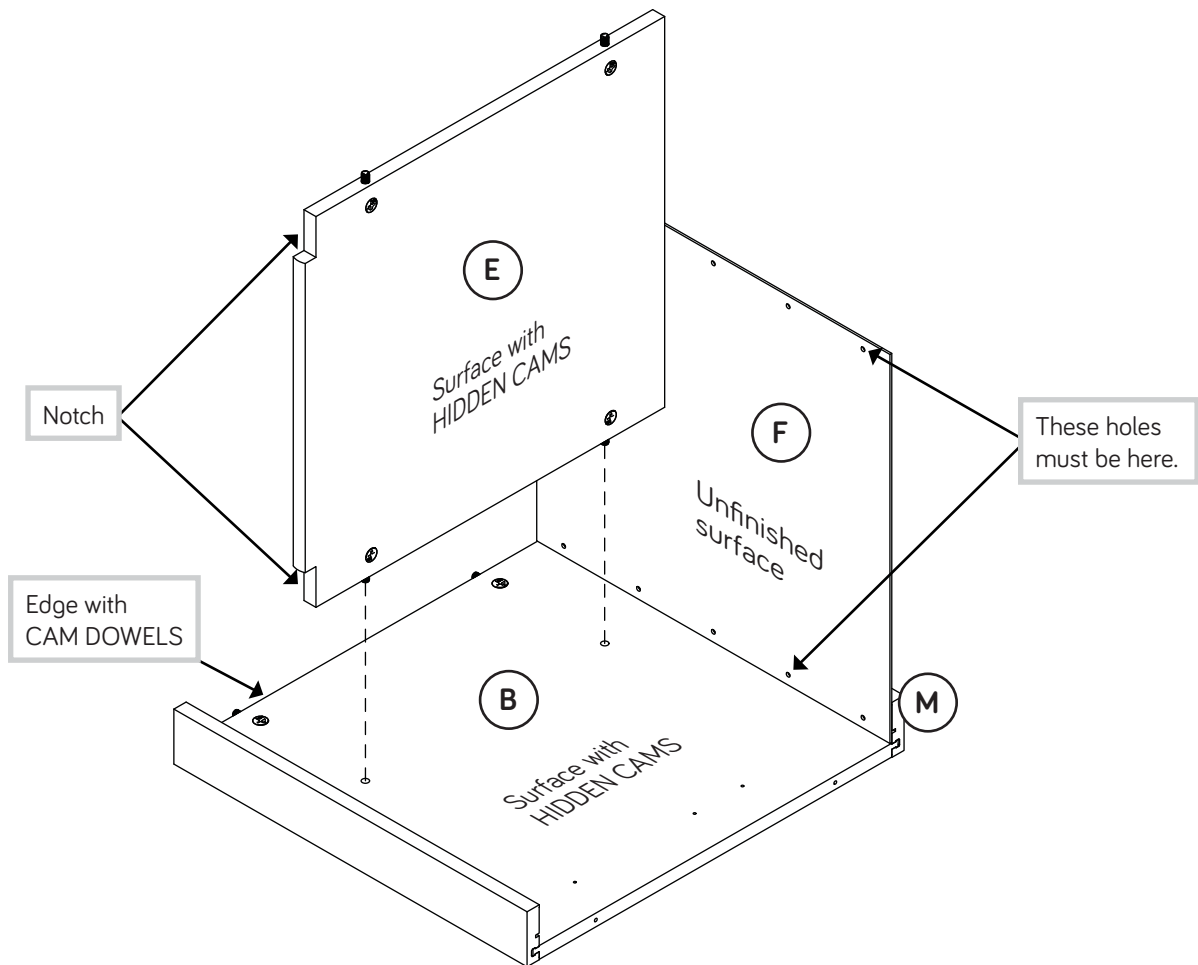

## ⚠ Caution

Risk of damage or injury. HIDDEN CAMS must be completely tightened. HIDDEN CAMS that are not completely tightened may loosen, and parts may separate. To completely tighten:

### Start

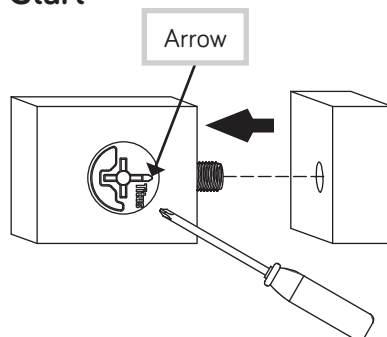

### Tighten

Maximum 210 degrees

Minimum 190 degrees

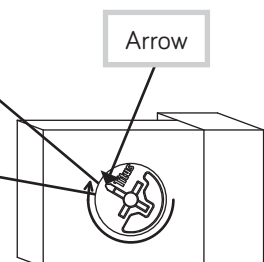

# Step 6

✚ Fasten the RIGHT END (A) to the SHELF (E). Tighten two HIDDEN CAMS.

✚ NOTE: Be sure to center the BACK (F) evenly between the ends of the END MOLDINGS (M).

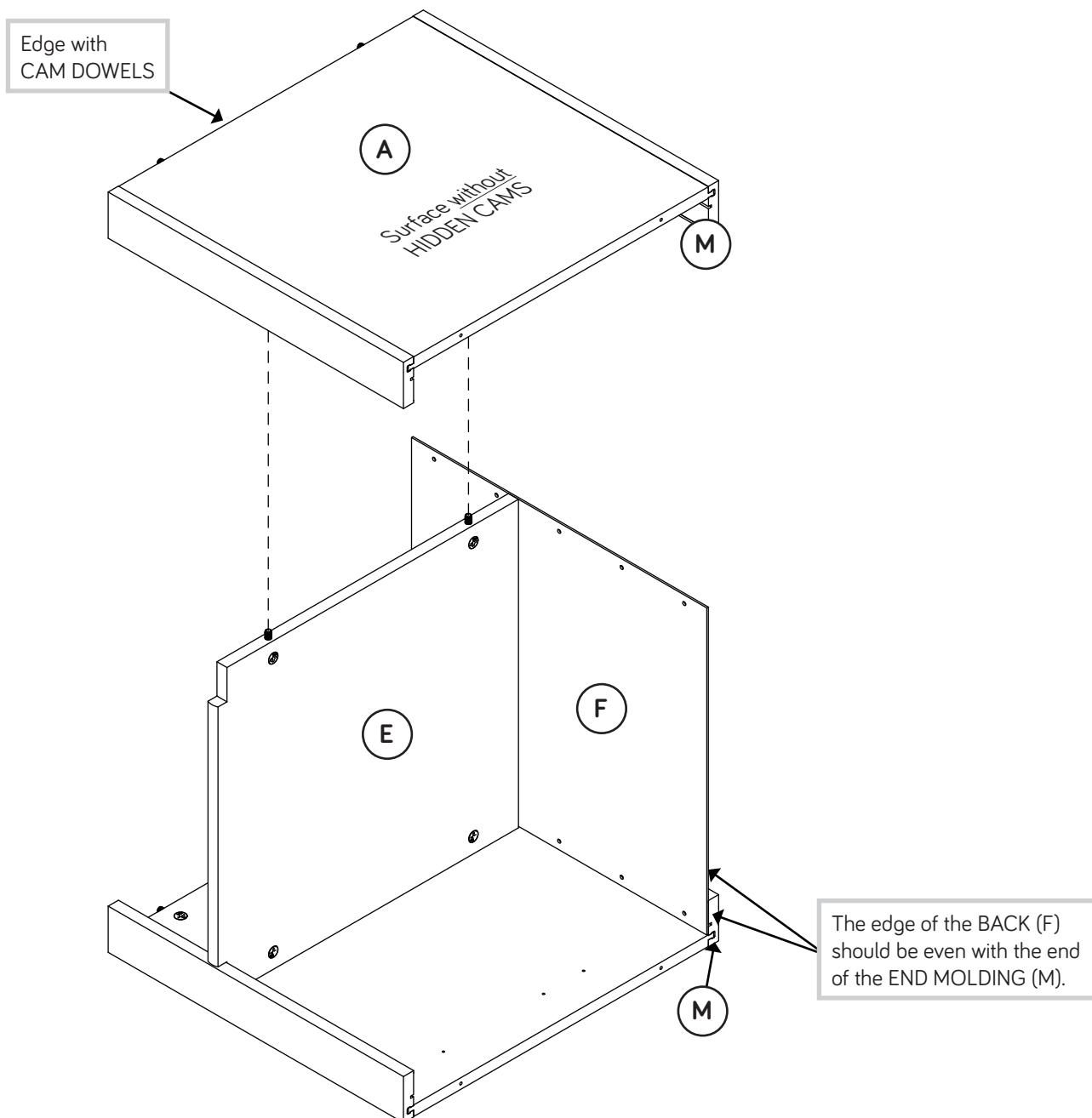
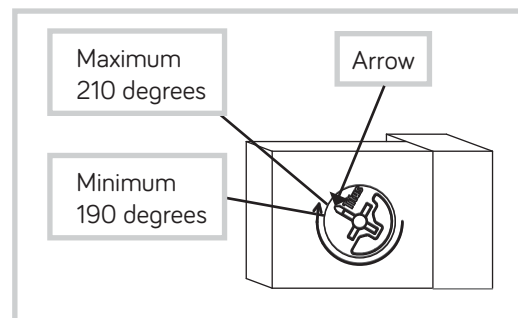

# Step 7

- ✚ Carefully turn your unit onto the BACK (F) and END MOLDINGS (M).
- ✚ Fasten the BACK (F) to the END MOLDINGS (M). Use ten BLACK 9/16" LARGE HEAD SCREWS (1S).
- ✚ NOTE: There are no pre-drilled holes in the END MOLDINGS (M). The SCREWS will tighten into the grooves.
- ✚ Fasten the VALANCE (I) to the END MOLDINGS (M). Use two SILVER 1-1/8" FLAT HEAD SCREWS (10S).
- ✚ NOTE: There are no pre-drilled holes in the END MOLDINGS (M). The SCREWS will tighten into the grooves.

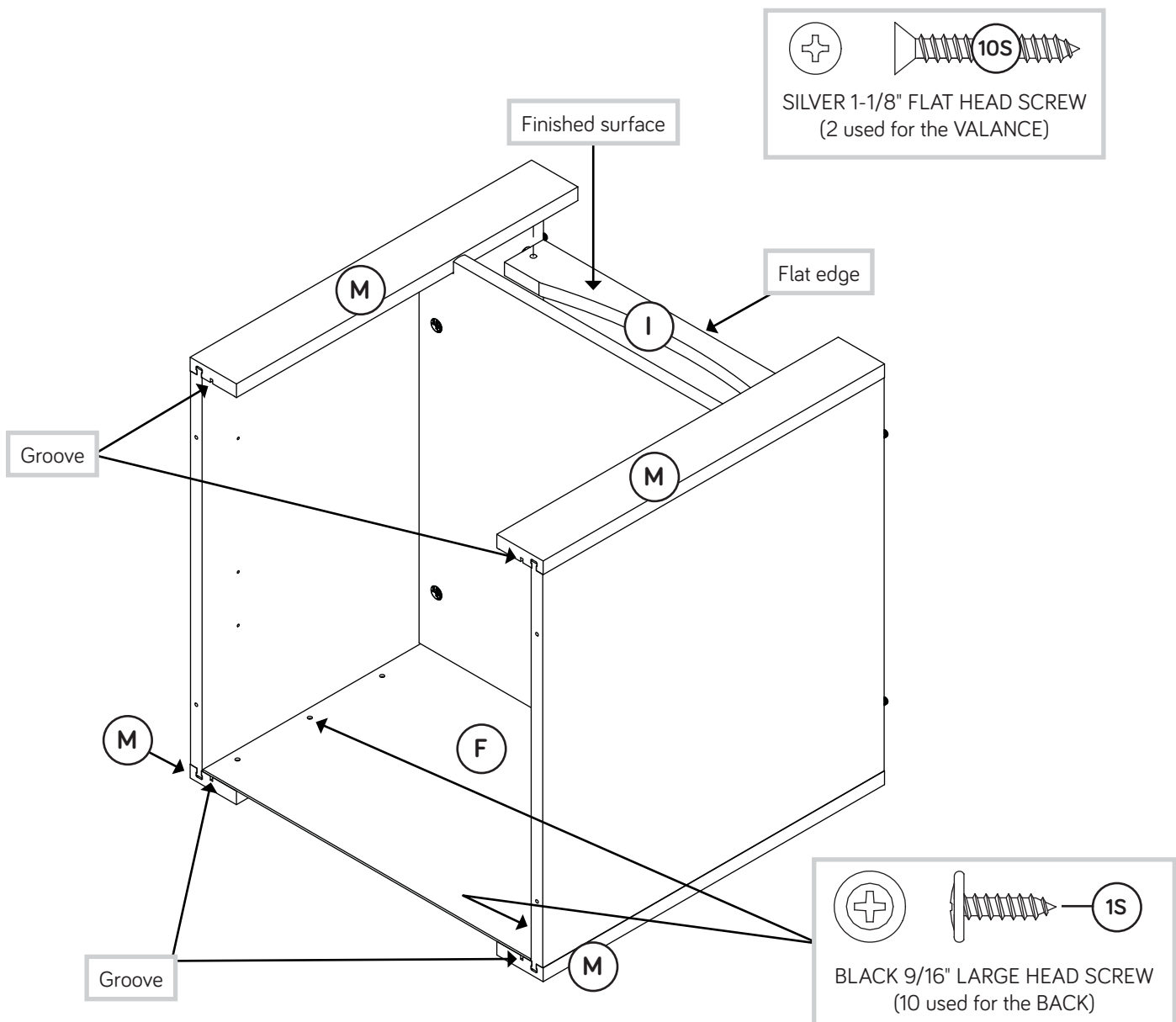

# Step 8

- Fasten the ENDS (A and B) to the SIDE TOP MOLDINGS (K). Tighten four HIDDEN CAMS.

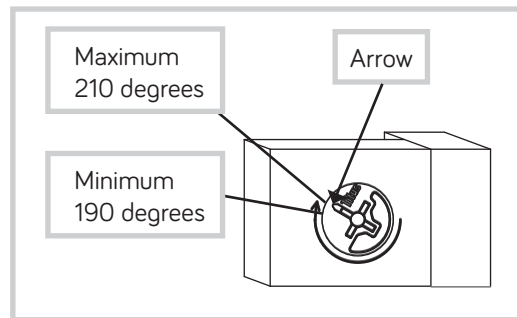
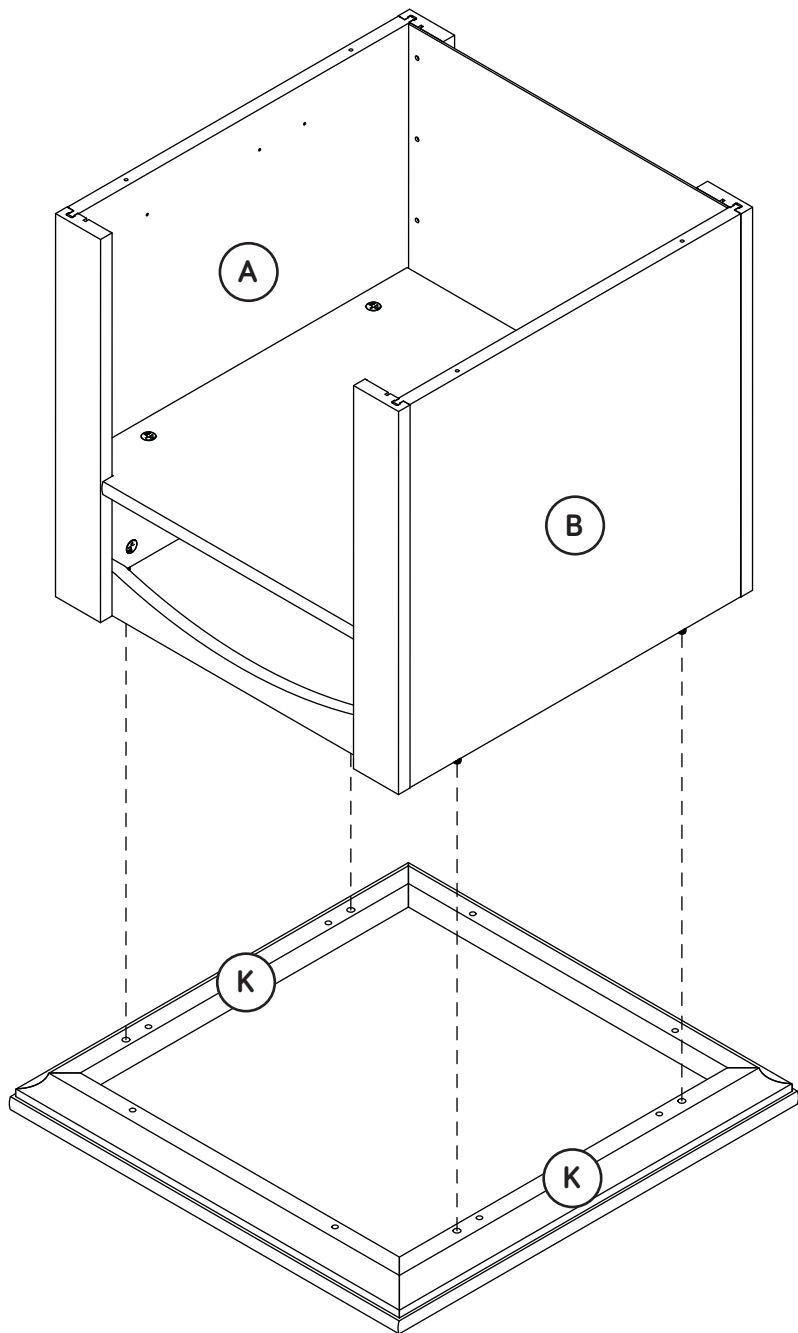

# Step 9

- Fasten the EXTENSION BRACKETS (45G) to the ENDS (A and B). Use eight BLACK 9/16" LARGE HEAD SCREWS (1S).



Now might be a good time to refresh your drink.

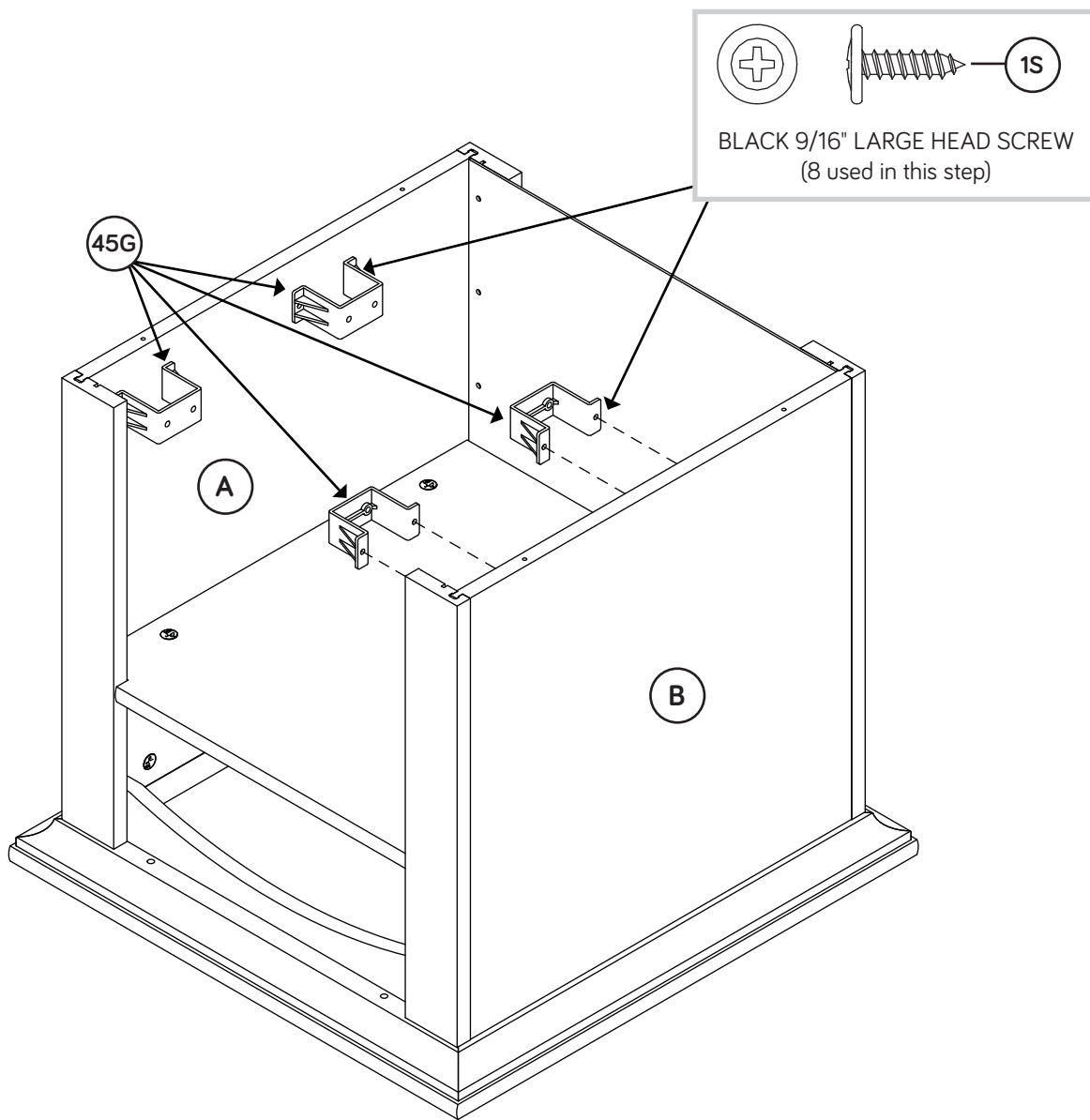

# Step 10

- Fasten the UNIVERSAL CABINET RAILS\* (35AA) to the EXTENSION BRACKETS (45G) in the exact holes shown. Use four GOLD 5/16" FLAT HEAD SCREWS (3S).

\*patent pending glide system

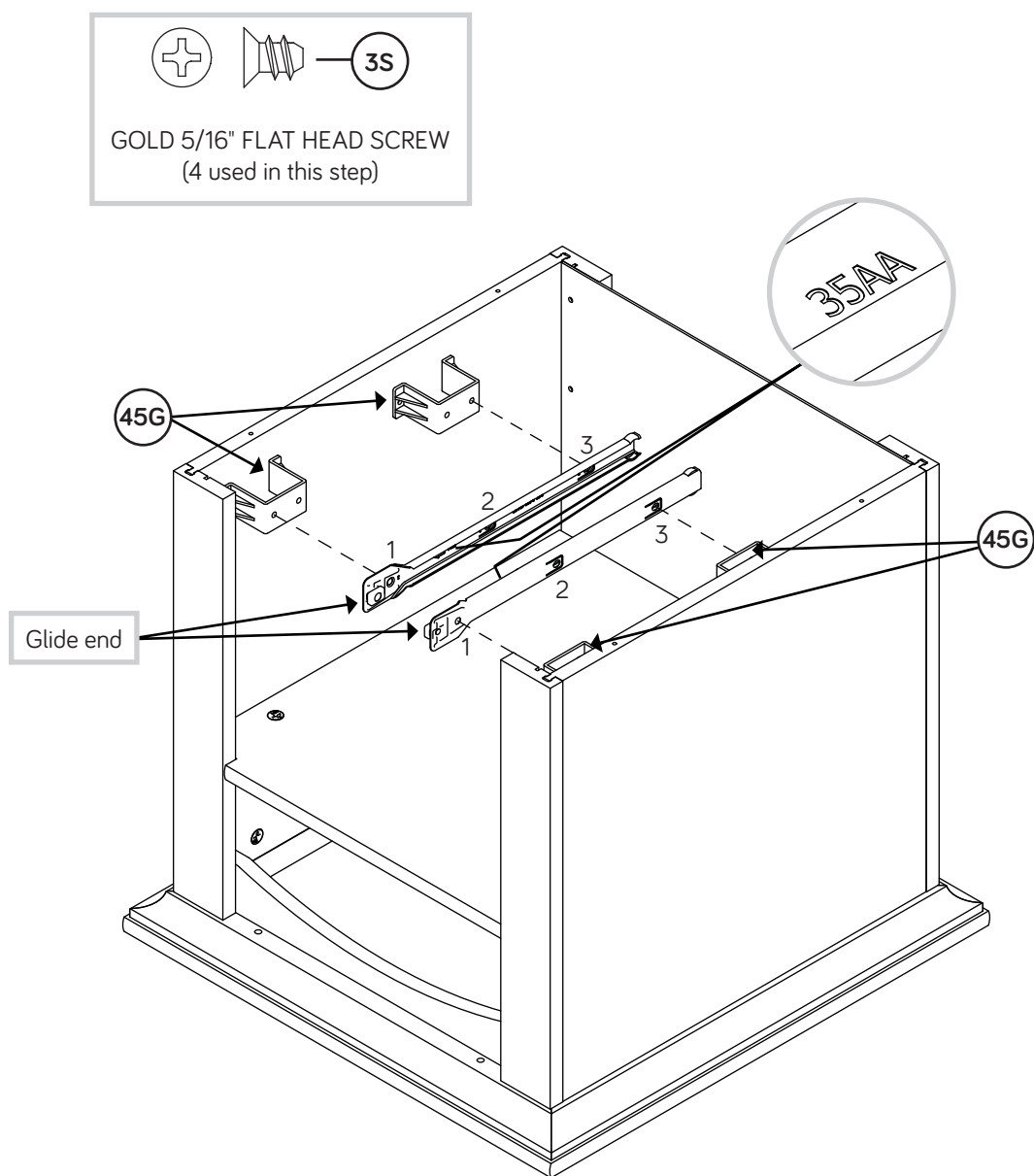

# Step 11

- Fasten the BOTTOM (D) to the ENDS (A and B). Use four BLACK 1-15/16" FLAT HEAD SCREWS (113S).

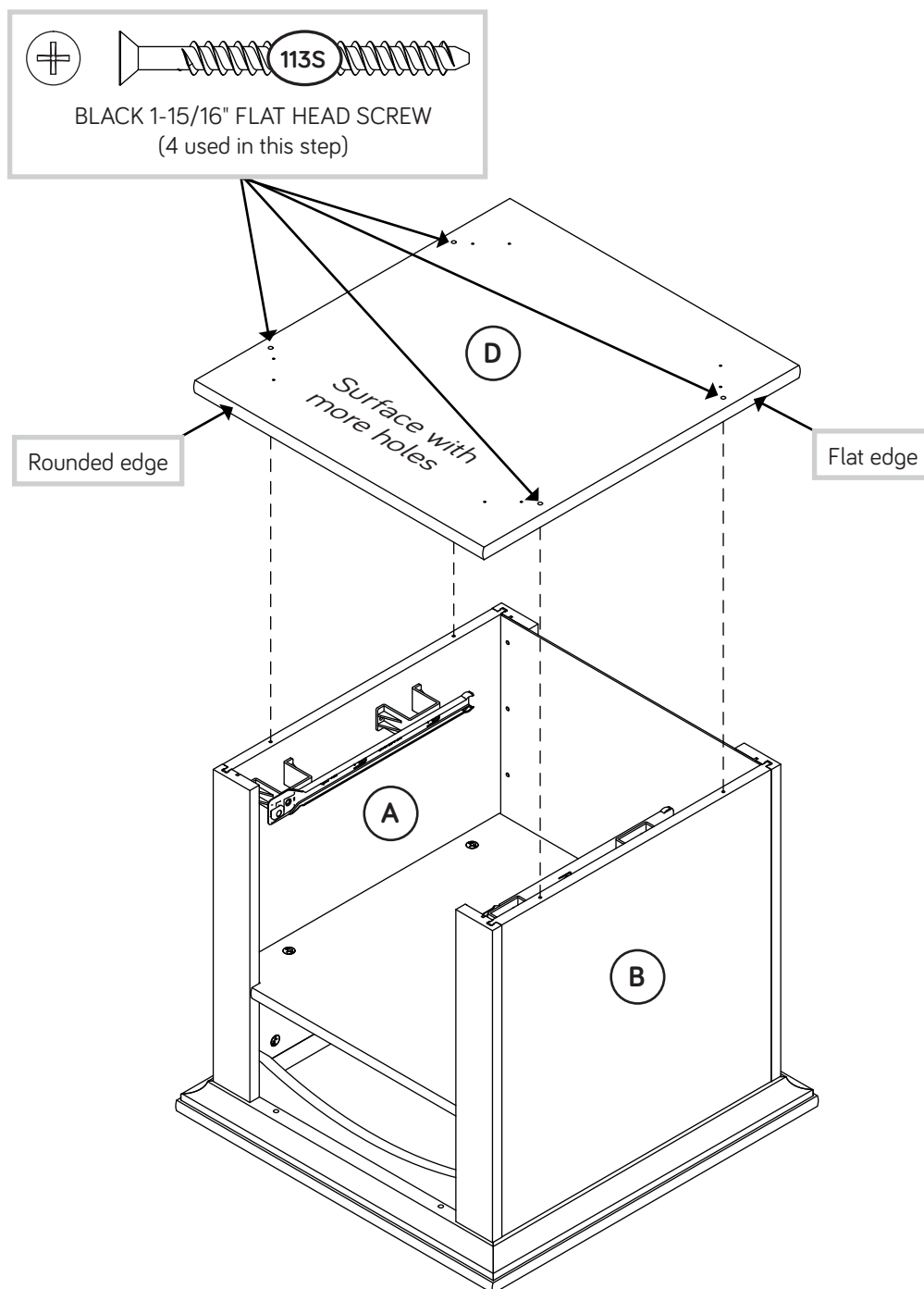

# Step 12

- ✚ Fasten the BASES (G) to the PLINTHS (P). Use eight SILVER 1-1/8" FLAT HEAD SCREWS (10S).

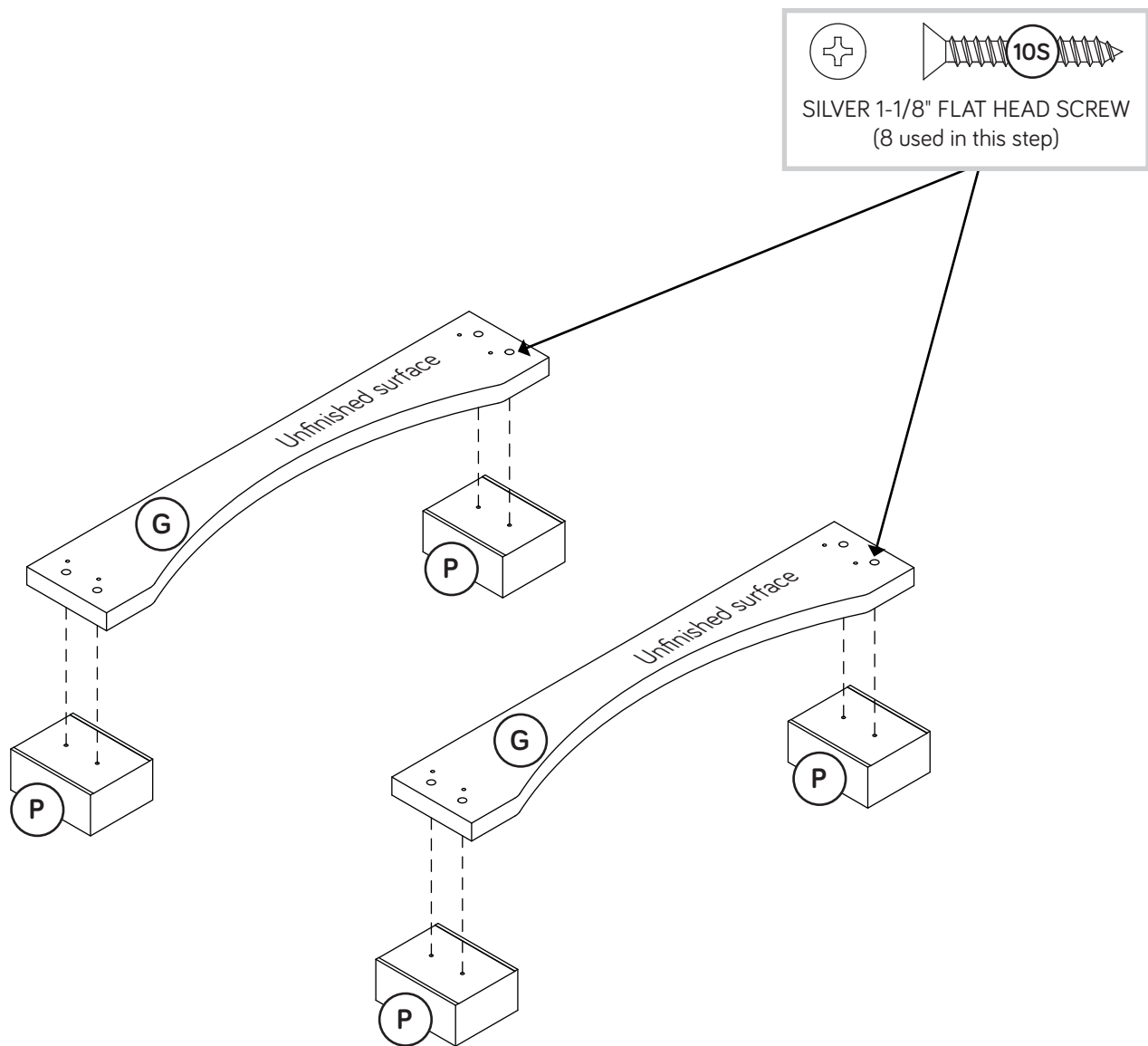

# Step 13

- Fasten the CORNER BRACKETS (31G) to the BOTTOM (D).  
Use eight BLACK 9/16" LARGE HEAD SCREWS (1S).

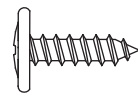

1S

BLACK 9/16" LARGE HEAD SCREW  
(8 used in this step)

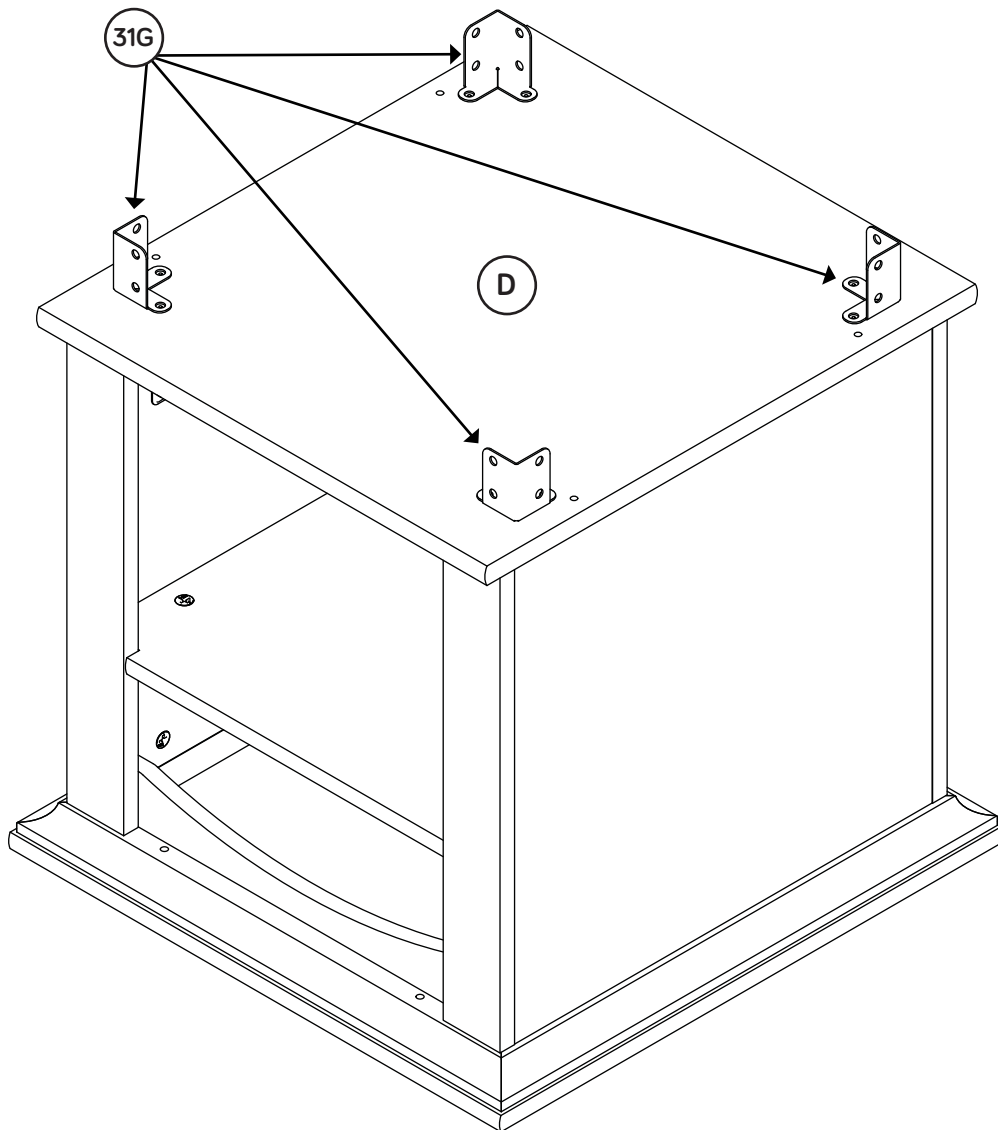

# Step 14

- Fasten the BASES (G) to the CORNER BRACKETS (31G).  
Use eight BLACK 9/16" LARGE HEAD SCREWS (1S).

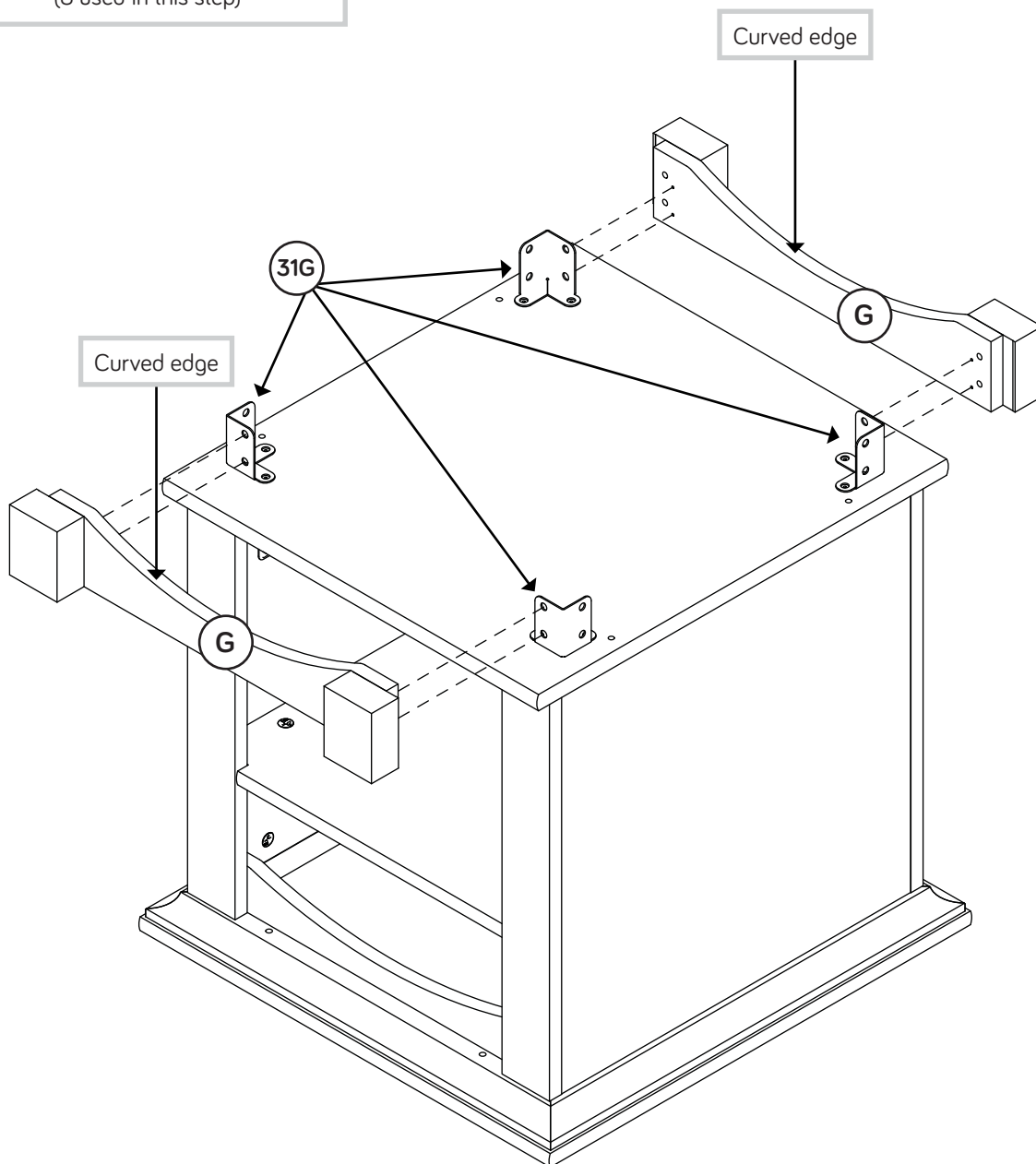
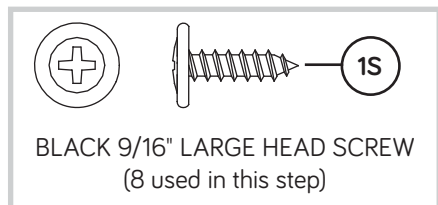

# Step 15

- Fasten the SIDE BASES (H) to the CORNER BRACKETS (31G).  
Use eight BLACK 9/16" LARGE HEAD SCREWS (1S).

**NOTE:** You may need to loosen the SCREWS in the CORNER BRACKETS (31G) to line up all of the holes. Once all of the holes are lined up, retighten the SCREWS in the CORNER BRACKETS.



Don't worry. It isn't Rome. This can be built in a day.

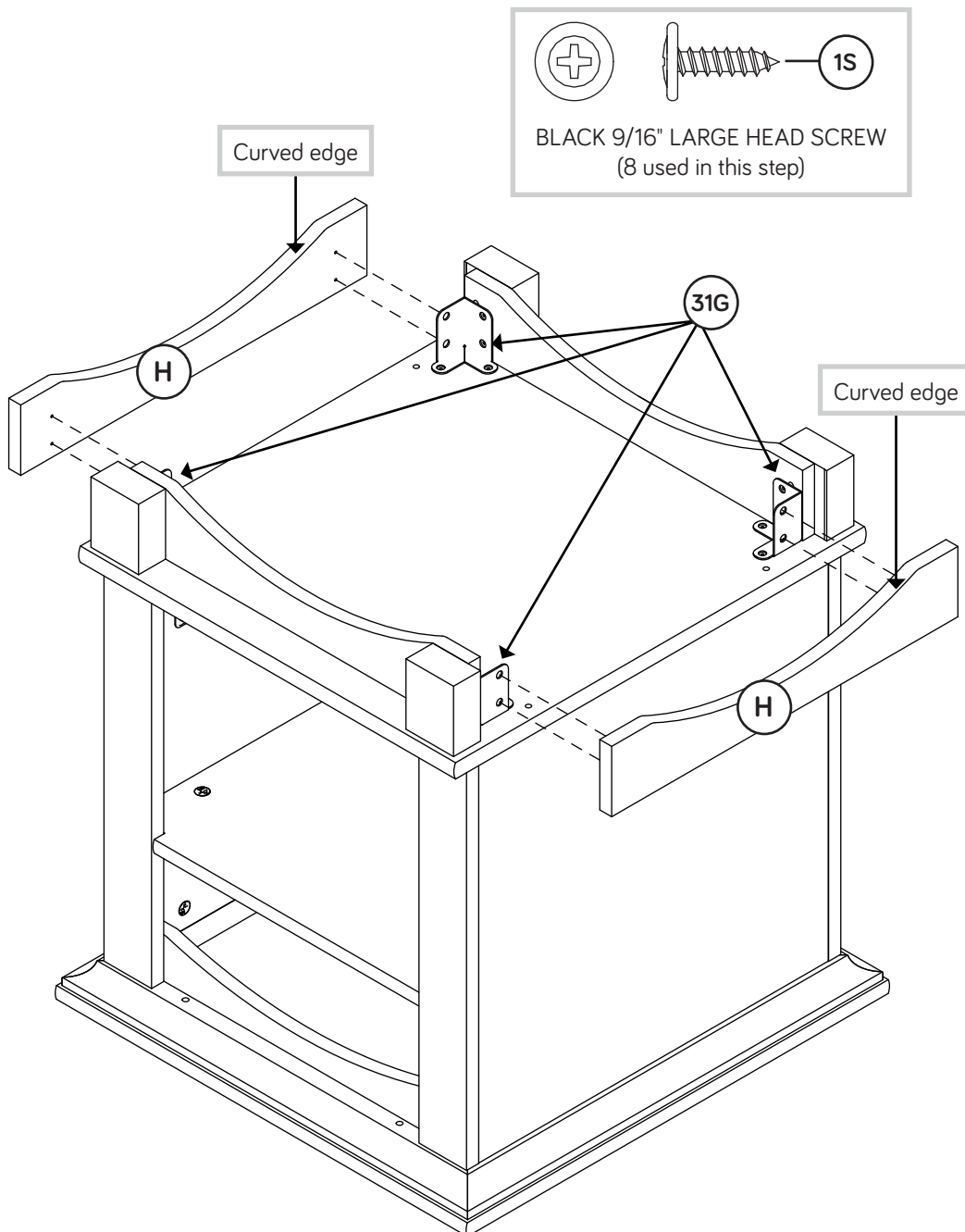

# Step 16

1

The tabs should insert freely into the slots. Gently tilt the DRAWER SIDES side to side until the tabs slip into the slots.

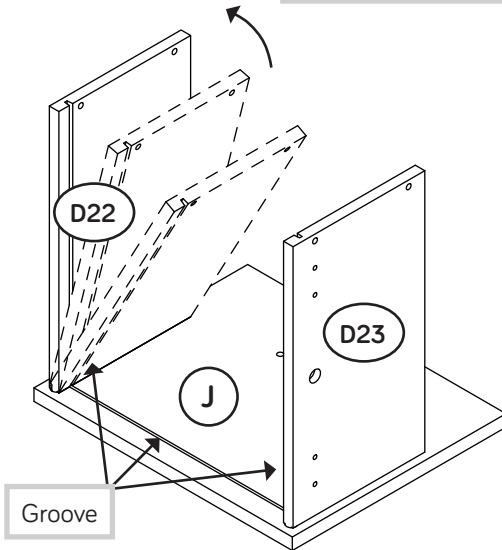

- ✚ Insert the DRAWER SIDES (D22 and D23) at an angle into the slot at each end of the DRAWER FRONT (J).

2

With the palm of your hand, tap the DRAWER BOTTOM down into the groove.

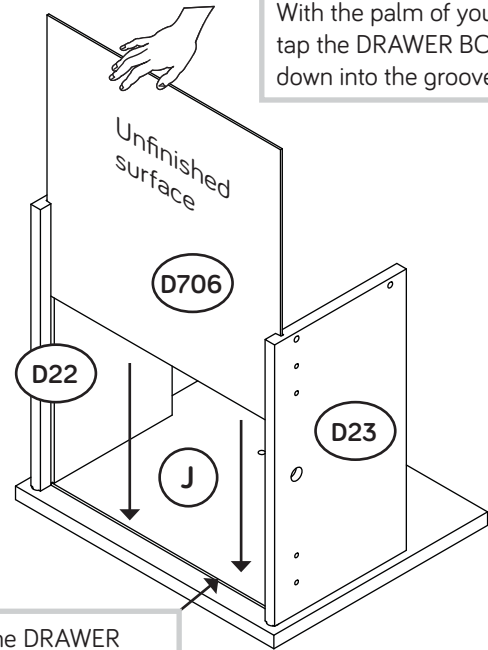

Be sure the DRAWER BOTTOM inserts into the DRAWER FRONT groove.

- ✚ Slide the DRAWER BOTTOM (D706) into the grooves in the DRAWER SIDES (D22 and D23) and DRAWER FRONT (J).

3

Be sure the DRAWER BOTTOM inserts into the DRAWER BACK groove.

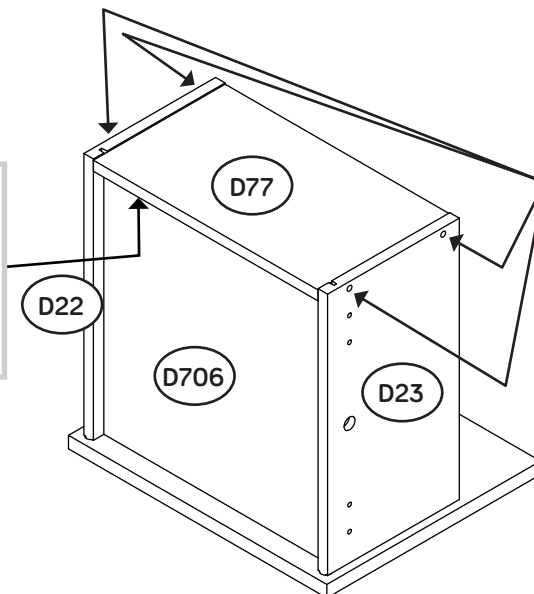

Start each screw a few turns before completely tightening any of them.



BLACK 1-9/16" FLAT HEAD SCREW  
(4 used in this step)

- ✚ Fasten the DRAWER BACK (D77) to the DRAWER SIDES (D22 and D23). Use four BLACK 1-9/16" FLAT HEAD SCREWS (30S).
- ✚ NOTE: Be sure the DRAWER BOTTOM (D706) inserts into the groove of the DRAWER BACK (D77).

# Step 17

- ✚ Insert a SLIDE CAM (10A) into the DRAWER SIDES (D22 and D23).
- ✚ Fasten a DRAWER RIGHT (35AC) to the DRAWER RIGHT SIDE (D22) and a DRAWER LEFT (35AD) to the DRAWER LEFT SIDE (D23). Use four GOLD 5/16" FLAT HEAD SCREWS (3S) through holes #1 and #2.
- ✚ NOTE: The screw head in the CAM must be visible through the slotted hole in the SLIDE.
- ✚ NOTE: The glides are not intended to rotate.
- ✚ Fasten the PULL (98K) to the DRAWER FRONT (J). Use two SILVER 5/8" MACHINE SCREWS (15S).

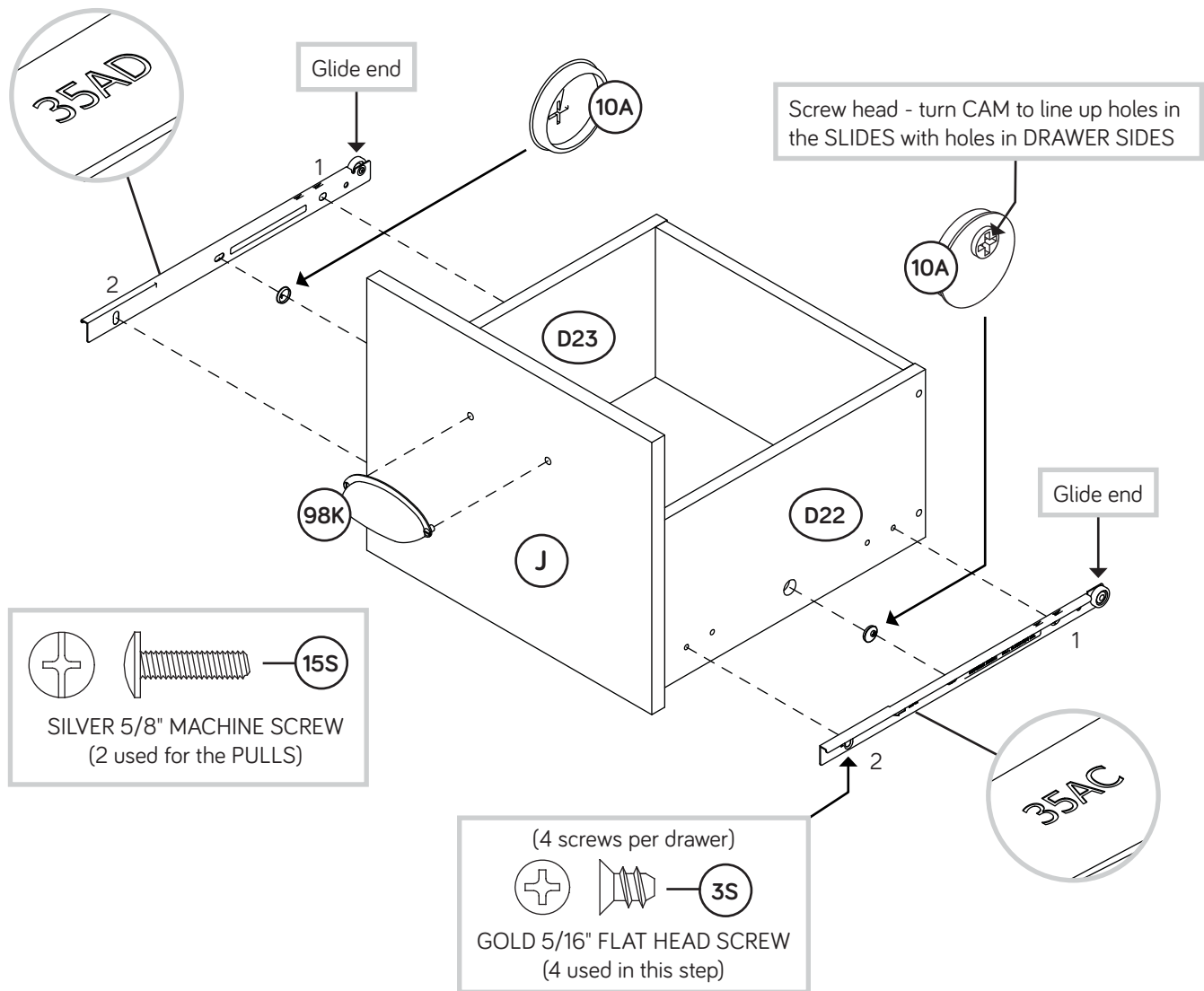

# Step 18

- ✚ Carefully stand your unit upright.
- ✚ To insert the drawer into your unit, tip the front of the drawer down and drop the glides on the drawer behind the glides on the unit. Lift the front of the drawer up and slide it into the unit.

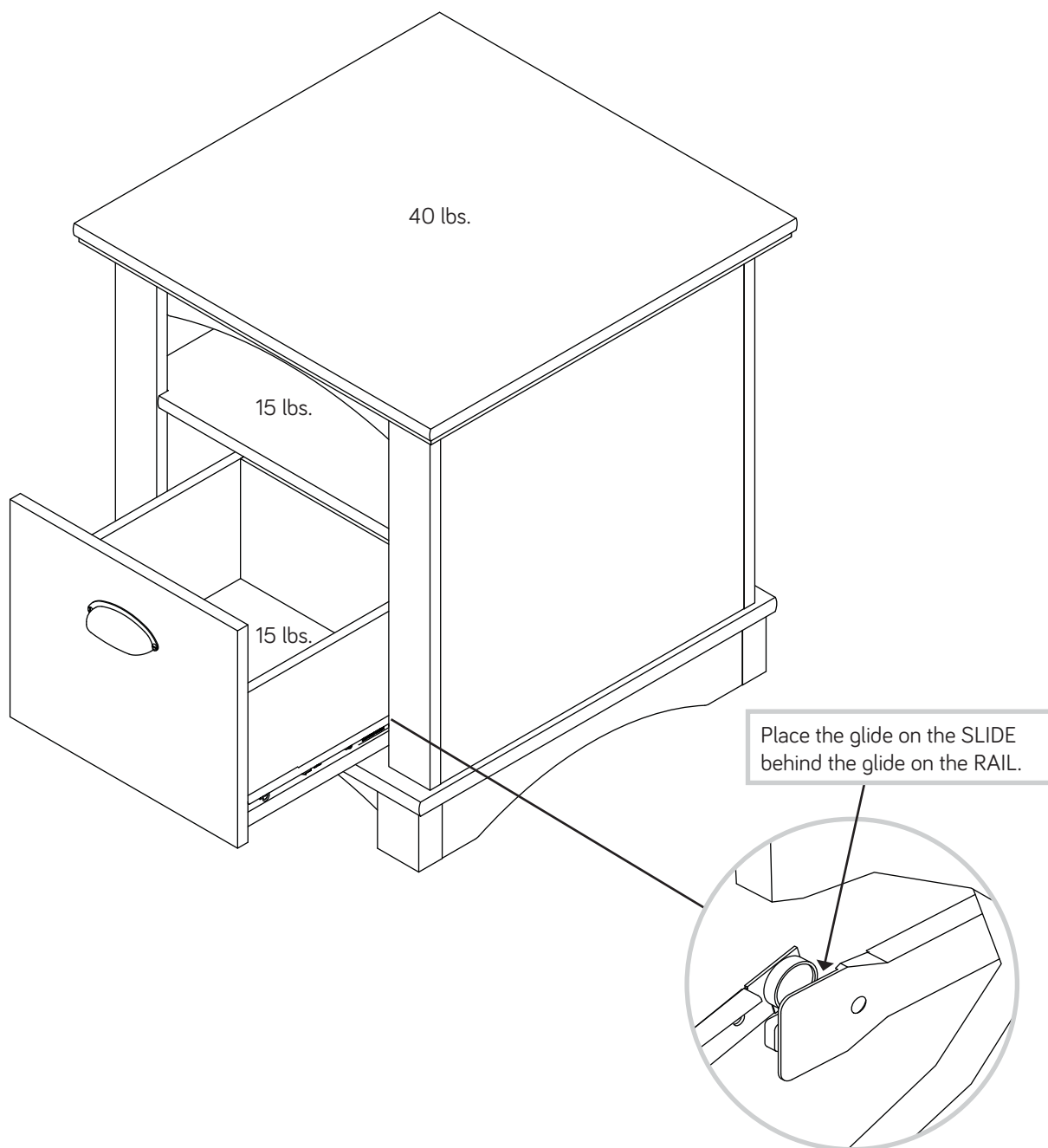

# Step 19

- ✚ To make adjustments to the drawer, loosen SCREW #2 in the SLIDES a 1/4 turn, then turn the CAM clockwise or counter-clockwise. Notice how the drawer raises or lowers as you turn the CAM. The higher the screw in the oblong hole, the higher your drawer front will be. The lower the screw, the lower the drawer front. By adjusting the drawer this way, it will help the DRAWER FRONT line up better when closed. Tighten the SCREW when finished with adjustments.
- ✚ **NOTE:** Please read the back pages of the instruction booklet for important safety information.
- ✚ This completes assembly. Clean with your favorite furniture polish or a damp cloth. Wipe dry.

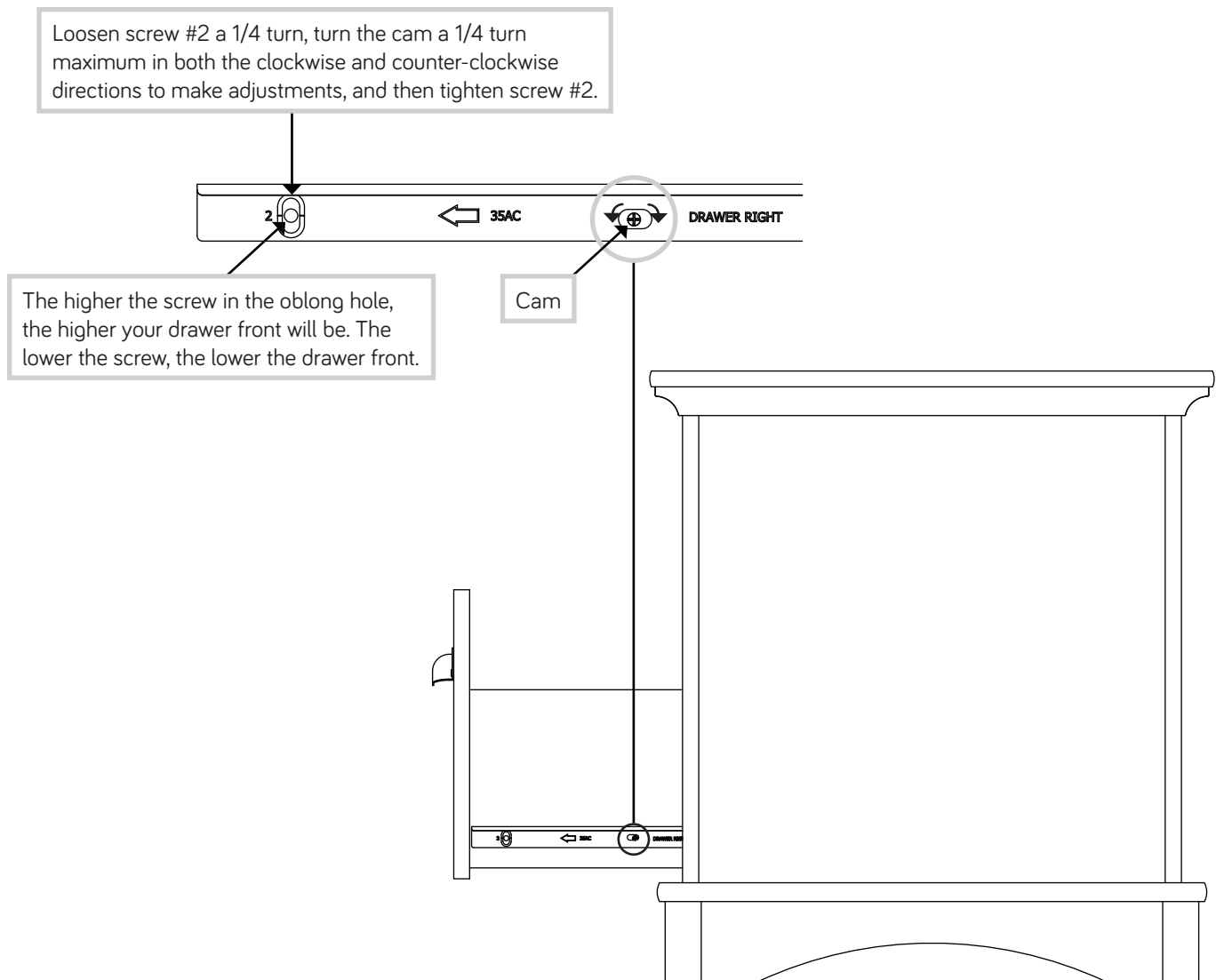

 **WARNING**

Please use your furniture correctly and safely. Improper use can cause safety hazards, or damage to your furniture or household items. ***Carefully read the following chart.***

Look out for:	What can happen:	How to avoid the problem:
<ul style="list-style-type: none"><li>• Overloaded drawers and shelves.</li></ul>	<ul style="list-style-type: none"><li>• Risk of injury.</li><li>• Top-heavy furniture can tip over.</li><li>• Overloaded drawers or shelves can break.</li></ul>	<ul style="list-style-type: none"><li>• Never exceed the weight limits shown in the instructions.</li><li>• Work from bottom to top when loading shelves and drawers. Place the heavier items on the lower shelves or in lower drawers.</li></ul>
<ul style="list-style-type: none"><li>• Placing TVs on furniture items that are not designed to support a television is hazardous.</li></ul>	<ul style="list-style-type: none"><li>• Risk of injury or death. TVs can be very heavy. Plus the weight and location of the picture tube tends to make TVs unbalanced and prone to tipping forward.</li></ul>	<ul style="list-style-type: none"><li>• This product is not designed to support a television.</li></ul>